



包缝车与 VD 的完美搭配
PERFECT APPLICATION WITH
OVERLOCK AND VD DEVICE

MJ SERIES

AC servo motor

Coming soon in 2009

NEW!

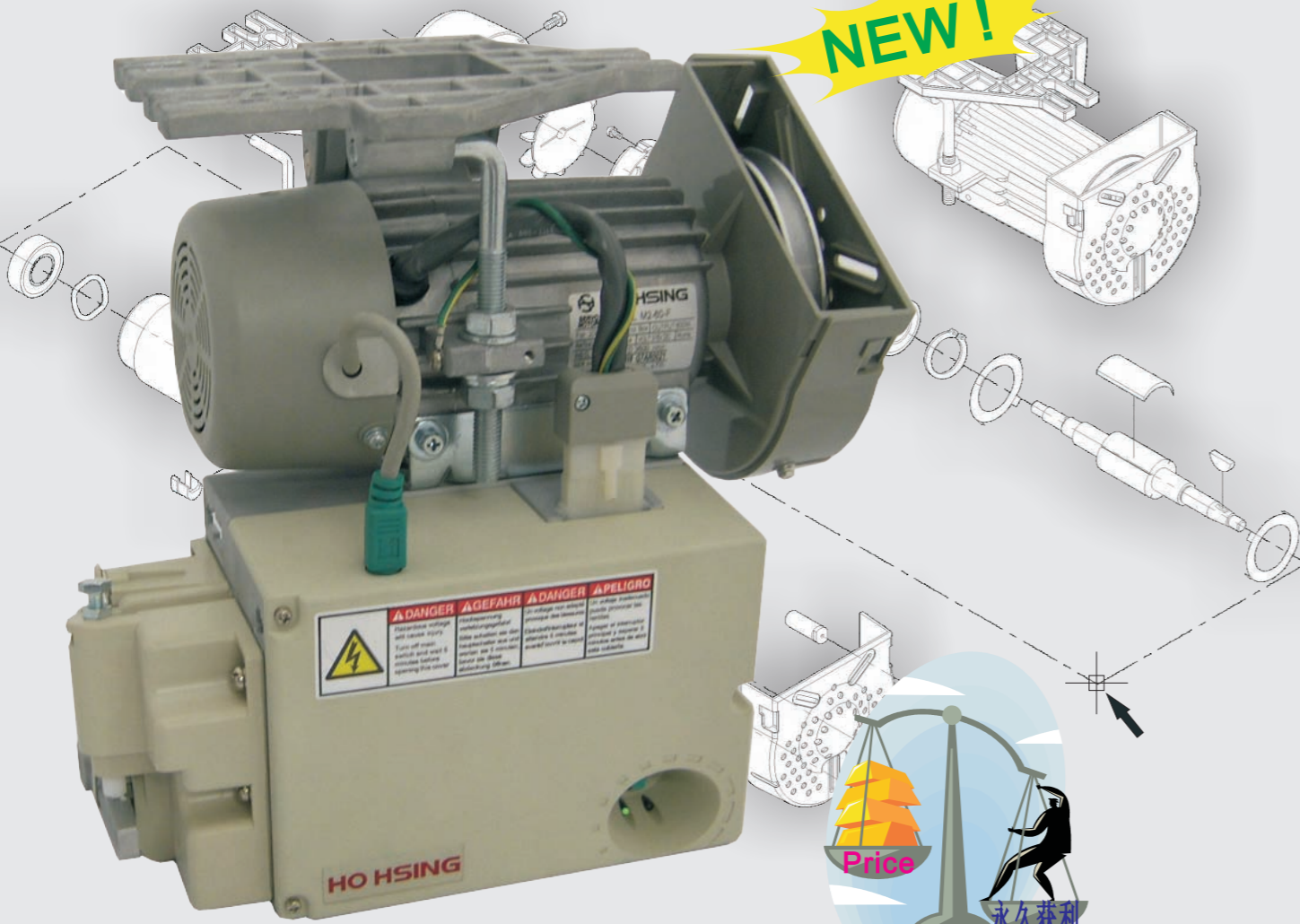

高效率环保节能伺服电机

HIGH PERFORMANCE ECO-SERVO MOTOR

环保产品，低污染。
无耗材，替您节省成本。
低噪音，低耗能。
车缝速度调整旋钮。
无参数，无复杂设定，随装即用。
380V 可供选择。

Environmental product, less pollution.
Consumable free, save the cost for you.
Less noise, low power consumption.
Sewing speed adjusting knob.
Parameter free, no complicated setting; just install and operate.
380V available.

伺服电机比离合器电机贵？

SERVO MOTOR IS EXPENSIVE THAN CLUTCH MOTOR?

事实上，不同产品的架构及零件和功能设计上
是会造成价格上的差异没错。但以投资获利及
附加价值的观点上来看，节能上的永久获利并
兼顾环保价值将远远超过一时的价差。

The true is, different products with different features
have price difference. But see it as the investment
gain and its high value added, the saving profit and
environmental value are great gains far beyond the one time price.



賀欣機械廠股份有限公司
H.S.MACHINERY CO., LTD.
<http://www.hohsing.com>

Specification / 规格

Actual weight might be different depend by the varied accessories
实际重量会依配件的不同而有所差异

Function	机能	MJ-1
Motor Type	电机出力	500W-5000 rpm. (转)
		600W-3500 rpm. (转)
Power Voltage Range	电压范围	Single Phase (单相) : 200~240V
Pulley Size Available	皮带轮尺寸	65、75、85 mm
Speed Adjusting Knob	调速旋钮	★
External 12V LED Socket	外接 12V LED 插座	★
Soft Start	慢速启动	★
Needle Position	针定位	★
Trimmer (MT) ※	剪线	★
Tension Release (ML)	松线	★
Needle Cooling (NCL)	针冷却	★
Presser Foot (AFL)	押脚	★
Input Signal Port	入力信号数	0
Solenoid Signal Output Port	电磁铁出力信号数	1
Air Pressure Output Port	气压式出力信号数	3
Gross Weight - kg	毛重 - 公斤	500W= 5.3
		600W= 6
Packing Dimension	包装尺寸	380(L) X 300(W) X 220(H) mm

※ Use solenoid signal output / 使用电磁铁出力信号

* () = Weight for 380V / 380V的毛重

Dimension / 尺寸图

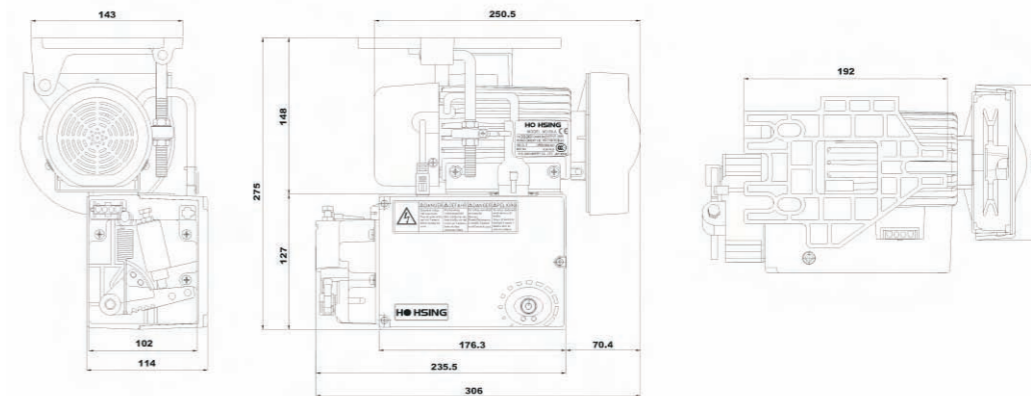

mm

Model Code / 编码规则

Control box / 电控箱

MJ-1-00-2 15-CE

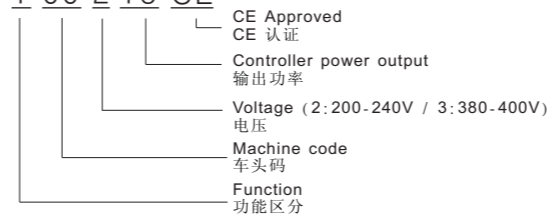

Motor / 电机

M2-50-A

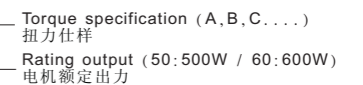

All the technical data, dimensions and weights are for reference only, and are subject to change without notice.
For other products information please contact our sales representative or visit our web site at www.hohsing.com



賀欣機械廠股份有限公司
H.S.MACHINERY CO., LTD.

台北縣樹林市中正路632巷5號
NO. 5 LANE 632 CHUNG CHENG RD.,
SHULIN CITY, TAIPEI HSIEN, TAIWAN
TEL : +886-2- 2689-5501~2 (REP.)
+886-2- 2688-5742, 2688-6044
SERVICE : +886-2676-5203
FAX : +886-2- 2689-6600, 2689-3657
E-MAIL : sales@hohsing.com.tw

<http://www.hohsing.com>

MJ

高效率环保节能伺服电机 HIGH PERFORMANCE ECO-SERVO MOTOR

+

VD 集尘装置搭配应用 Venturi Device Application

与您一同关心环保
We care the environment

创新设计排风孔



INNOVATION DESIGN EXHAUST HOLES

专利申请中！
Patent Pending!

创新设计，在集尘袋满时可防止气压回流及乱窜，有效避免车缝废料阻塞。

Innovation design, prevent the air feedback and wrong direction while waste bag full, effectively eliminates sewing waste blocking.

集尘容量加大 25%

500 mm X 220mm X 120mm

节少您清理的次数
Reduce your maintenance time



WASTE CAPACITY INCREASE 25%

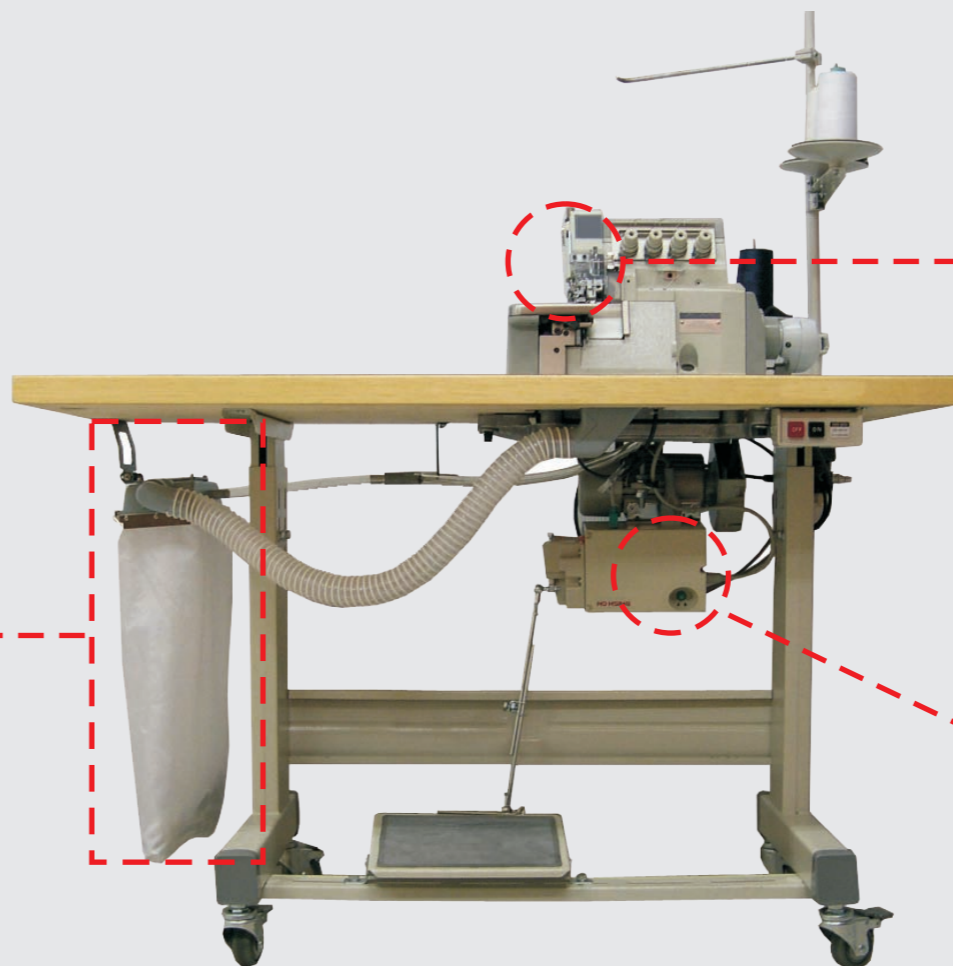

透明吸风管设计

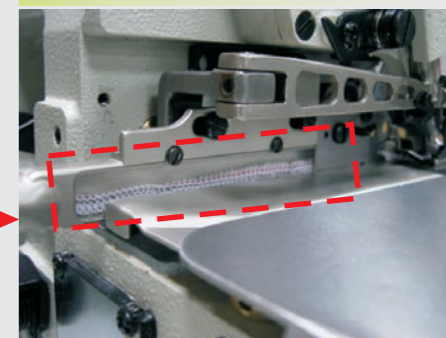

TRANSPARENT SUCTION PIPE

车缝废料吸入状态清晰可见
CLEAR VIEW OF WASTE SUCTION

调速旋钮



CONVENIENT FOR YOUR SPEED CONTROL

SPEED ADJUSTING KNOB

节能
SAVING

省电达到80%
Energy save 80%

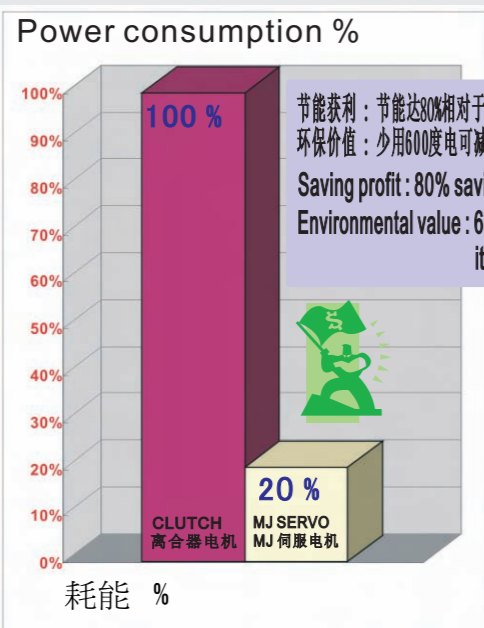

节能获利：节能达80%相对于一年中可节省600度的电费。
环保价值：少用600度电可减少450公斤二氧化碳，也等于您为地球种了一百棵树。
Saving profit: 80% saving can save about 600 kw power per year.
Environmental value: 600 kw power reduce 450 kg CO2, it is equivalent to plant 100 trees for Earth by you.

效率
EFFICIENCY

效率提升50%
Efficiency up 50%

搭配VD装置，效率更加提升
Increase your work efficiency with Venturi Device



好的工作环境提升更高的工作效率
Fine work environment increase high work efficiency.

3500转时噪音低于75分贝 The noise is under 75 decibel when running in 3500 rpm.
振动测试振幅低于250微米 The amplitude of vibration is less 250 um.

环保
ECO

符合 RoHS
RoHS complied

无耗材，环保且节省成本。
Consumable free, save the cost and the environment.



环保基板设计，低毒害，可回收。
ECO-CIRCUIT BOARD DESIGN
Less contaminate and recyclable

有毒物质限量指令
Concentration Limits for Certain Hazardous Substances

有毒物质 / Hazardous Substance	限量要求 / Permissible Values
铅 Lead (Pb)	低于 240 ppm / Less than 240 ppm
汞 Mercury (Hg)	低于 800 ppm / Less than 800 ppm
镉 Cadmium (Cd)	低于 80 ppm / Less than 80 ppm
六价铬 Hexavalent chromium (Cr VI)	低于 800 ppm / Less than 800 ppm
多溴联苯 Polybrominated Biphenyl (PBB)	低于 800 ppm / Less than 800 ppm
多溴二苯醚 Polybrominated Diphenyl ether (PBDE)	低于 800 ppm / Less than 800 ppm